

LYNX700

www.hirecworld.com

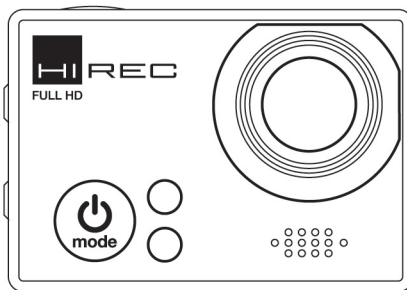

USER MANUAL

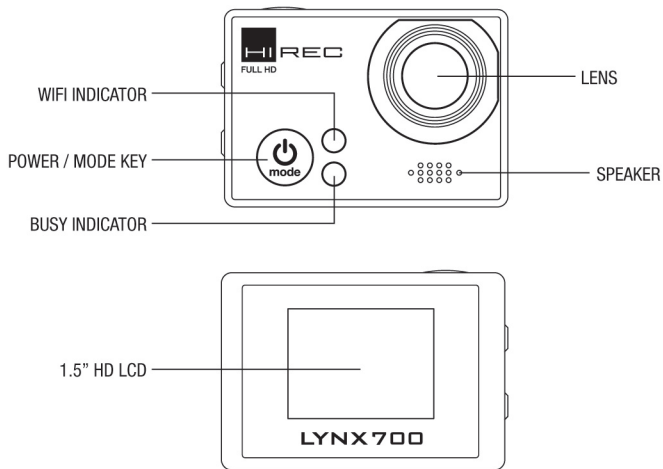

English

Introduction to appearance and keys

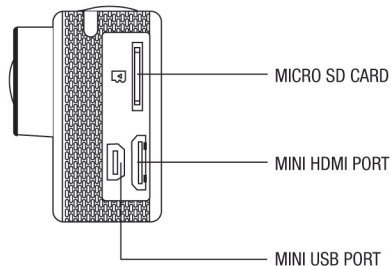
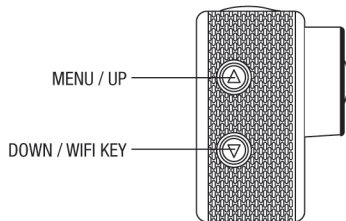
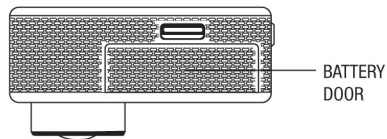
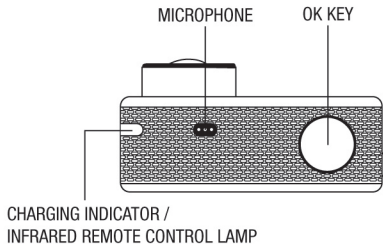



Select Language

1. Start the camera  press the Menu / Up Key 
2. Press mode key
3. Navigate in setting menu  and select your language

Start using

1.Charge the built-in Lithium battery

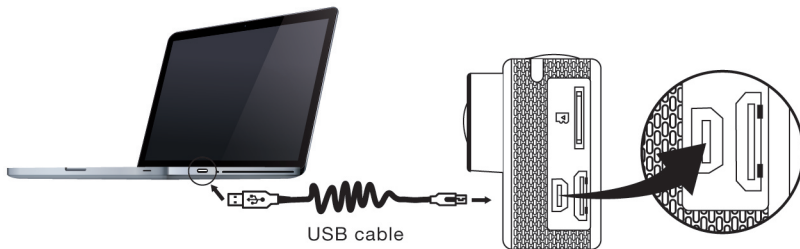

Connect the camera to the computer for charging, at this time, the charging indicator will be in red, and it will be off after charging. Generally, it takes 3-5 hours to charge the battery.

2. Use the storage card

2.1. Push the TF card into the slot till it is in place as per the instruction in concavely engraved words by the storage card slot.

2.2. To take out the TF card, press the tab of the storage card inwardly softly and it will be popped out.

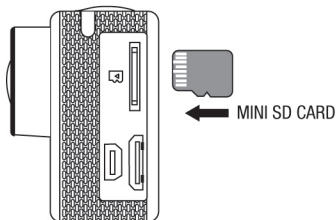

NOTE: There's no built-in memory unit in the camera, so make sure to insert a storage card into it prior to use (it is recommended that a TF card of better quality be used, like as class 6 speeds or better card).

2. Use the storage card

2.1. Push the TF card into the slot till it is in place as per the instruction in concavely engraved words by the storage card slot.

2.2. To take out the TF card, press the tab of the storage card inwardly softly and it will be popped out.

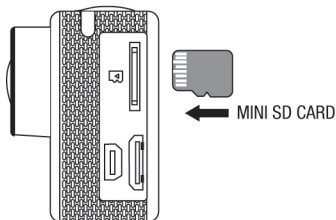

NOTE: There's no built-in memory unit in the camera, so make sure to insert a storage card into it prior to use (it is recommended that a TF card of better quality be used, like as class 6 speeds or better card).

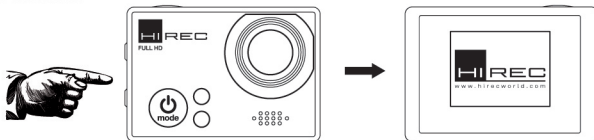

3.Power ON/OFF

3.1.Power ON: Press Power key for 1 second, the screen will be ON, and the camera will be started.



3.2.Power OFF: Hold on Power key for 3 seconds when the camera is in the idle state to turn it off.

3.3.Auto Screen OFF: The screen will be turned off automatically when the time that the camera is in the idle state for automatic screen off to save the power.

3.4.Power off when the camera is lack of electricity. When electricital quantity of the battery is very low, an icon of  will be displayed on the LCD screen, prompting you to charge it in time. When the icon of  will be displayed on the LCD screen, the camera will be turned off automatically.

4.Shift among functional modes

The camera has 4 modes: namely video recording mode / shooting mode / replay mode / car-carrying mode. After power is on, press Power key to shift among them.



*Video
recording
mode*



*Car-carrying
mode*



*Shooting
mode*



*Replay
mode*

5.Indicator

Busy indicator (red): when the camera is busy such as recording videos, shooting photos the work indicator will flicker.

WIFI indicator (red): when turn on the WIFI, the work indicator will light.

Charging indicator (red): when it is on, the user is prompted that the camera is being charged and it will be off after charging is completed.

6.Video recording mode

After power is on, the video camera After power is on, the video camera will enter video recording mode directly and in preview mode, press OK key to start video recording; Press it again to stop shooting.

If the memory card is full or electrical quantity is low, it will also stop shooting:

1. Icon of mode, indicating video recording mode
2. Indicate quality of video
3. Indicate size of video: 1440P (30FPS) / 1080P(60FPS)/1080P(30FPS) / HD 720P(120FPS) / HD 720P(60FPS) is optional
4. Recording time, indicating recordable length of time
5. Icon of battery, indicating current electrical quantity



Note: short press POWER Key to realize the camera video process and save the image.

7.Car-carrying mode

After power is on, press Power key to enter video car-carrying mode.

1. Icon of mode, indicating car-carrying mode
2. Indicate quality of video
3. Indicate size of video: 1440P (30FPS)/1080P(60FPS)
1080P(30FPS)/ HD 720P(120FPS)
/ HD 720P(60FPS) is optional
4. Recording time, indicating recordable length
of time
5. Icon of TF,indicating TF card is inserted



Prompt:

In car-carrying mode, a passage of video is kept every three minutes in recording. After the storage card is full, the earliest passage will be deleted, and video will be recorded in a circulating way.

8. Shooting mode

After power is on, press Power key twice to enter shooting mode, and in preview state, press OK key to take a photo:

1. Icon of mode, indicating the current is shooting mode
2. Size of video, and 5M/8M/10M/12M is optional
3. Counter, indicating number of photos to be taken
4. Icon of battery, indicating current electrical quantity

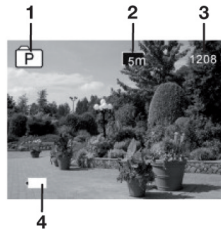

9. Replay mode

9.1 After power is on and entering Preview state, press Power key continuously to shift to Replay mode.

Select the file to be replayed through the menu as follows:

Select CAR to replay files in car-carrying video mode

Select VIDEO to replay files in general video mode

Select JPG to replay files in shooting mode

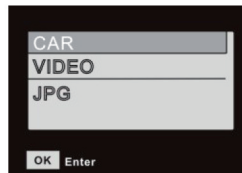

9.2 Introduction to play screens

9.2.1 Screens of video files

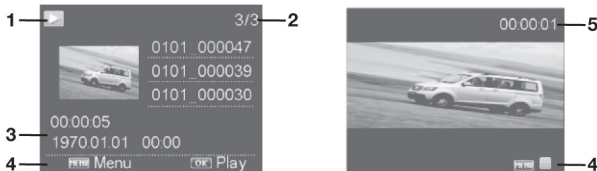

1. Icon of replay mode
2. Indicate serial number of current file / total number of files
3. Indicate parameter of recording time
4. Operation buttons hint icon
5. Indicate recording time point.

When a video file is being played, click OK key to pause play, and click Menu key to stop playing.

9.2.2 Screen of photos



1

1. Indicate serial number of current file / total number of files

In replaying, Press Down key to select other file type, in a circulating way.

10. Menu operation

There is a different menu in each working mode as shown in the following figures:



*Menu for
video recording /
Car-carrying mode*



*Menu for
shooting mode*

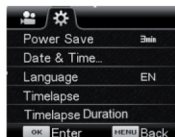

*Menu for
setting mode*

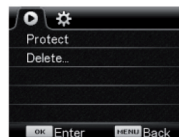

*Menu for
replay mode*

Operation:

Press Menu key, the menu for this mode will be displayed on the LCD.

At this time, press Menu key again to move the cursor leftward or rightward and select on the menu, and press Down key to move the cursor upward or downward and select on the menu in a circulating way.

Press OK key to confirm and press Menu key to return or exit from menu mode.

Application of remote controller

1. Definition of keys of remote controller

Keys of remote controller are as shown in the right figure:

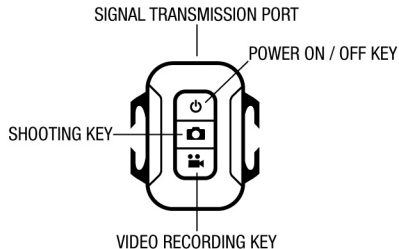

2. Use of remote controller:

Using the remote controller, you can achieve functions of video recording, shooting and power off without operating on the camera. Just point the signal transmission port of the remote controller at IR signal receiving lamp of the camera, and press corresponding keys to achieve functions of power on, video recording, shooting and power off.

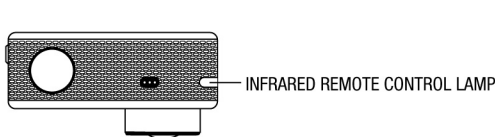

Connect device to HDTV:

Connect the video camera to an HDTV with a HD cable as shown in the following figure, display signals in the camera will be output into the HDTV automatically, and you can browse HD videos and photos that are recorded or taken in the HDTV.

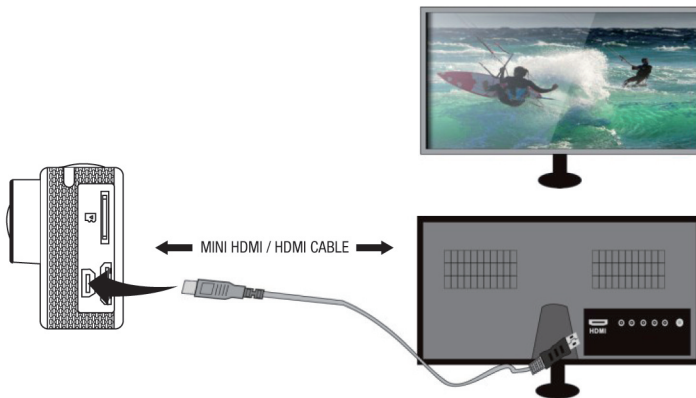

APP (for Android and iOS System)

How to Obtain the APP Installation Program

1. For the Android System, you can search “Sky Lark” in the Play Store to obtain corresponding installation programs, and then you can install them according to the indicated steps or through scanning the two-dimensional code
2. For the IOS System, you can search “Sky Lark” in the APP Store to obtain corresponding installation programs, and then you can install them according to the indicated steps or through scanning the two-dimensional code II. Camera WIFI and System Applications Android Applications
3. Please install the Sky Lark application program (provided by the Supplier or the Internet) for the Android mobile phone or tablet PC, and then the Display Screen will show the Icon 
4. Insert a Storage Card into the Camera and then power it on. Press the WIFI key to conduct WIFI connection, and the Screen of the Camera will show the WIFI signal Icon with the external screen revealing WIFI Connecting.

5. Enable the WIFI function of the Android mobile phone or tablet PC, and try to find the AP Name DV560SA_WIFI; please conduct connection between them till the system reveals a successful connection.

Note: if you are conducting WIFI connection for the first time, please input the password: 1234567890.

6. Tap and enable the Application Program Icon  on the Android mobile phone or tablet PC, you can directly view the preview picture transmitted by the Camera (see the following picture), and then conduct relevant operations.

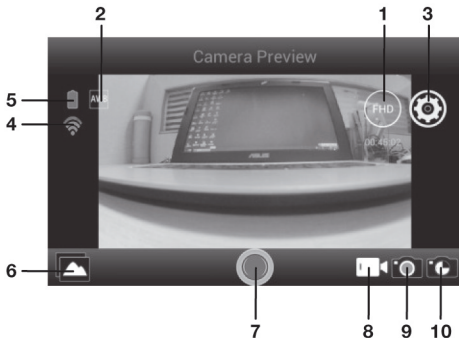

- 1.Resolution
- 2.White Balance
- 3.Settings (Enter Settings Menu)
- 4.WiFi Signal Icon
- 5.Camera's Battery Status Icon
- 6.Enter the Playback Mode
- 7.Shutter Button
- 8.Video Mode
- 9.Photo Mode
- 10.Timelaps Mode

IOS Applications

1. Please install the Sky Lark application program (provided by the Supplier or the Internet) for the IOS mobile, phone or tablet PC, and then the Display Screen will show the Icon



2. Insert a Storage Card into the Camera and then power it on. Press the WIFI key to conduct WIFI connection, and the Screen of the Camera will show the WIFI signal Icon with the external screen revealing WIFI Connecting.

3. Enable the WIFI function of the IOS mobile phone or tablet PC, and try to find the AP Name DV560SA_WIFI Please conduct connection between them till the system reveals a successful connection. if you are conducting WIFI connection for the first time, please input the password: 1234567890.

4. Tap and enable the Application Program Icon  on the IOS mobile phone or tablet PC.

You can directly view the preview picture transmitted by the Camera (see the following picture), and then conduct relevant operations.

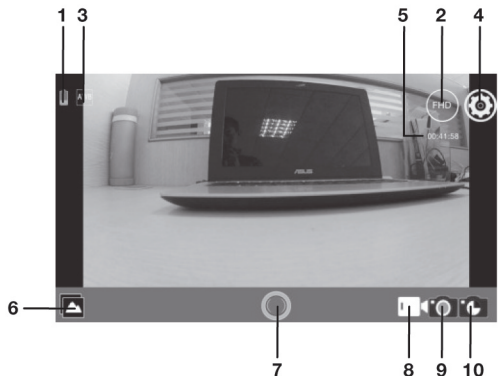

- 1.DV battery icon
- 2.Video resolution
- 3.White balance
- 4.Setup (enter setup menu)
- 5.Time
- 6.Enter the Playback Mode
- 7.Shutter Button
- 8.Video Mode
- 9.Photo Mode
- 10.Timelaps Mode

Notes:

1. If you need to record videos or download pictures using your mobile phone or tablet PC, please insert one TF card for your camera.
2. When the Camera has been successfully connected with your mobile phone or tablet PC, the WIFI Indicator Light will be on. Application on PC The camera has a plug-and-play function.

Connect the power-on device to the computer with the USB cable, and the mode can be automatically switched to the removable hard disk.

Removable disk icon will appear in the "My Computer" window.
The pictures you shot stored in the removable disk
H: \ jpg folder (H is this equipment removable disk)

Video files your shot stored in I: \ video folder; vehicle-mounted files you shot saved in I: \ CAR folder.

Note:

If using a mobile hard disk function on Windows 2000 or later versions of Windows operating system, do not install the driver.

In U-disk mode (MSDC mode), press the Shutter key to switch to web cam mode (PCCAM)

The LCD will display:PCCAM Now you can start the web cam through application.

To return to U-disk mode (MSDC mode), press the shutter key again.

Note:

Driver is not required for web cam mode (PCCAM mode) on Windows XP(SP3) version or above.

TECHNICAL FEATURES:

Image Sensor	8.0 Million Image Sensor
Function Modes	Video recording mode / Car-carrying mode / shooting mode & replay mode
Lens	F2.8 / f = 2.5mm
LCD Display Screen	1.5" HD LCD Screen
Photo Definition Ratio	12M / 10M / 8M / 5M
Video Definition Ratio	1440P 1920x1440(30fps) / FHD : 1920x1080(60fps) / FHD : 1920x1080(30fps) / HD : 1280x720 (120fps)
Storage Media	TF Card (32GB at most)
File Formats	Videos (MOV) / H.264 Compressed Format / Photos (JPEG)
USB Port	USB 2.0 Port
Power Supply	External 3.8V rechargeable lithium battery 1050mAh
Software Language	English / Chinese / Portuguese / German / Italian French / Korean / Japanese / Russian
Dimension	59mm x 41mm x 21mm

